

iBuyFireplaceParts.com

888-634-4289

iBuyFireplaceParts.com



This Manual describes the installation and operation of the Model S-408 E noncatalytic wood heater. This heater meets U.S. Environmental Protection Agency's emission limits for wood heaters sold after July 1, 1990. Under specific conditions this heater has been shown to deliver heat at rates ranging from 10,000 to 37,900 BTU per Hour.

Model No. S-408 E

This unit has been listed by Warnock Hersey Limited to meet or exceed ULC S-628

FIG. A

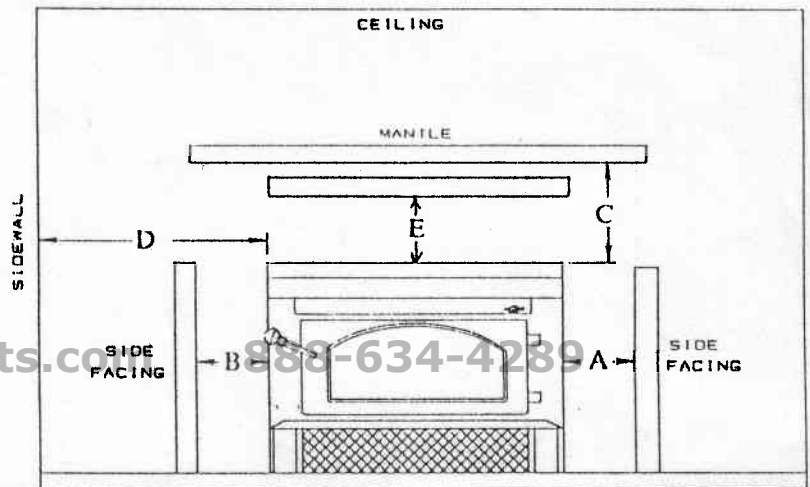
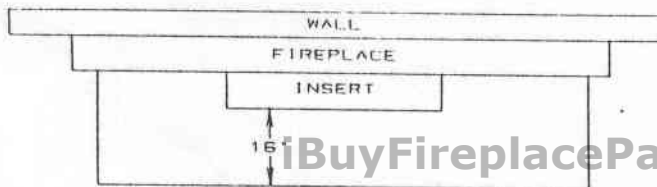

CLEARANCE FROM COMBUSTIBLE CONSTRUCTIONS

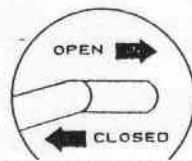

- A Right Side Facing 8"
- B Left Side Facing 8"
- C Mantle 15"
- D Sidewall 20"
- E Top Facing 12"

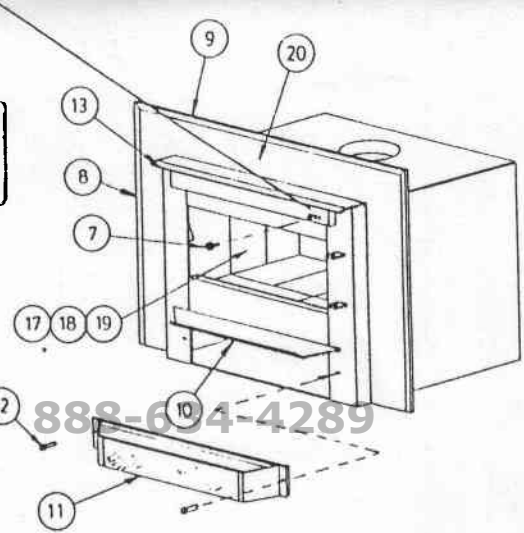
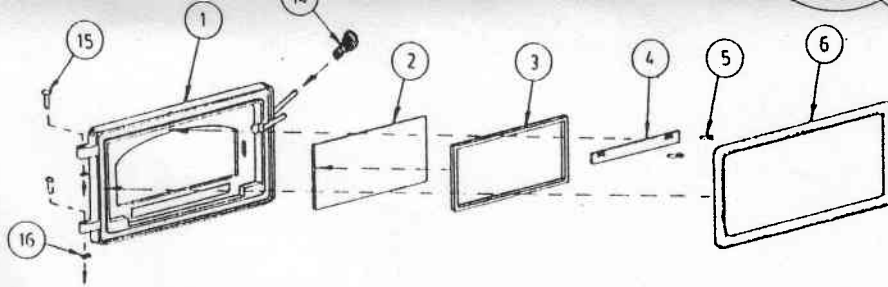

PARTS LIST S-408 E

#	QTY.	DESCRIPTION	PART #
1	1	Door	S41081
2	1	Glass	S10002
3	1	1/8" Glass Seal	S15001
4	1	Glass Clip	S37023
5	2	Screw	S11086
6	1	5/8" Door Seal	S15011
7	1	Air Control Spring Handle	S11008
8	2	Shroud Side Trim	S32019
9	1	Shroud Top Trim	S32018
10	1	Brass Ash Fender Trim	S32015
11	1	Fan Assembly	S31104
12	2	Fan Mounting Screw	S11087
13	1	Brass Body Trim	S32055
14	1	Spring Handle	S11007
15	2	Hinge Pin	S11005
16	2	Spring Nut	S11090
17	16	Brick 9" x 4-1/2"	S16001
18	1	Brick 4-1/2" x 4-1/2"	S16002
19	2	Brick Angled	S16013
20	1	Shroud	S41083

Blower Assembly

Remove screws from insert body, position fan and secure with the two screws previously removed. Blower unit should be removed occasionally for inspection, cleaned and lubricated when required (once or twice during the heating season should be sufficient). Be sure to disconnect power supply before servicing fan.

FIG. B

STEPS FOR BRICK PLACEMENT

- 1) Back brick 'A' to base of stove.
- 2) Bottom brick 'B'.
- 3) Angled brick 'C' slide to rear.
- 4) Side brick 'D' place front pieces first then add two middle bricks.

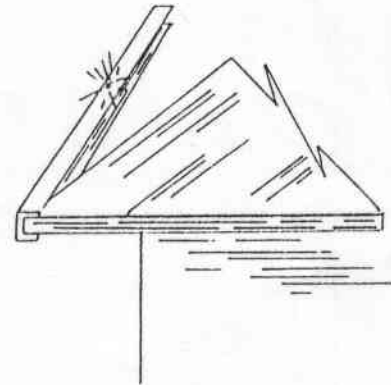
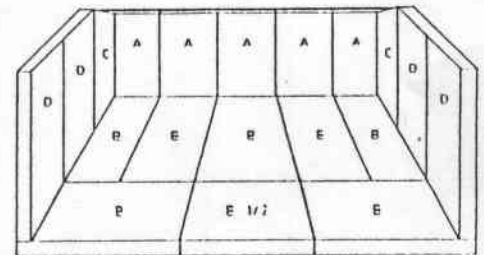

SPRING HANDLE

Twist spring handle in a counter clockwise motion while pushing on to handle; spring handle will "thread" down to desired location.

Part No. S10006

DECORATIVE TRIM

Trim is designed to simply push onto edge of stove top/ashfender. Be sure to remove protective plastic coating after installation.

S41081